



arthur grace
RESIDENTIAL



112 - 116 Broad Street, Chesham, HP5 3ED
£1,100 Per Month



Floor Plan

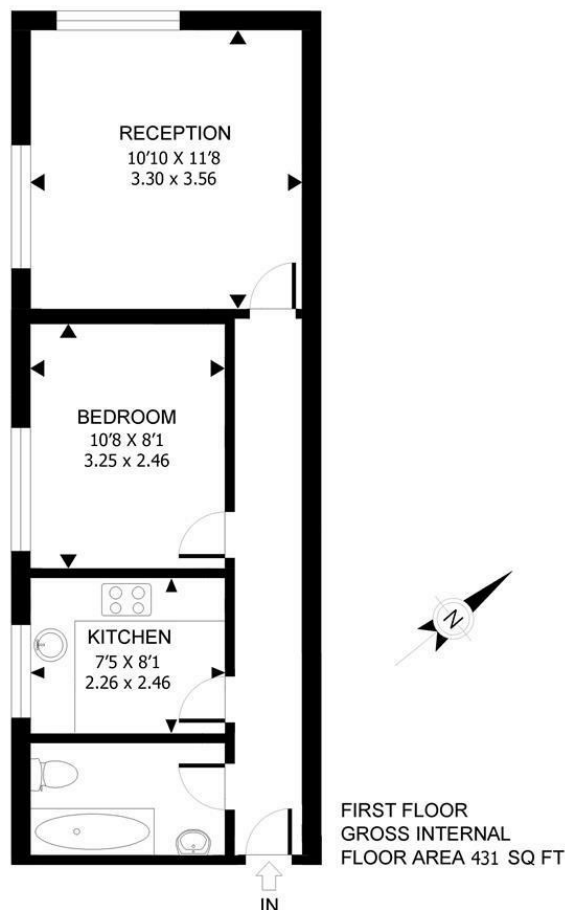

APPROX. GROSS INTERNAL FLOOR AREA: 431 SQ FT/ 40 SQM

Whilst every attempt has been made to ensure the accuracy of the floor plan contained here, measurements of the doors, windows, rooms and any other items are approximate and no responsibility is taken for any errors, omissions, or miss-statement. This plan is for illustrative purposes only and should be used as such by any prospective client. The services, systems and appliances shown have not been tested and no guarantee as to the operability or efficiency can be given.

Accommodation

- 1 Bedroom Apartment
- First Floor
- Separate Kitchen
- Short walk to Chesham High St & Station
- Double Glazing & Electric Heating
- Street Parking (permit required)
- Unfurnished (appliances included)
- Available now
- Council Tax A
- EPC C



These particulars, whilst believed to be accurate are set out as a general outline only for guidance and do not constitute any part of an offer or contract. Intending purchasers should not rely on them as statements of representation of fact, but must satisfy themselves by inspection or otherwise as to their accuracy. No person in this firm's employment has the authority to make or give any representation or warranty in respect of the property.

16 Packhorse Road Gerrards Cross, Buckinghamshire, SL9 7DA

Tel: 01753 628700 Email: enquiries@arthurgraceresidential.com <https://www.arthurgraceresidential.com>